

# Main Valve Body

## Disassembly/Inspection/Reassembly

### NOTE:

- Clean all parts thoroughly in solvent or carburetor cleaner, and dry with compressed air. Blow all passages.
- Replace valve body as an assembly if any parts are worn or damaged.
- Check all valves for free movement. If any fail to slide freely, see Valve Body Repair.

**CAUTION:** Do not use a magnet to remove the check balls; it may magnetize the balls.

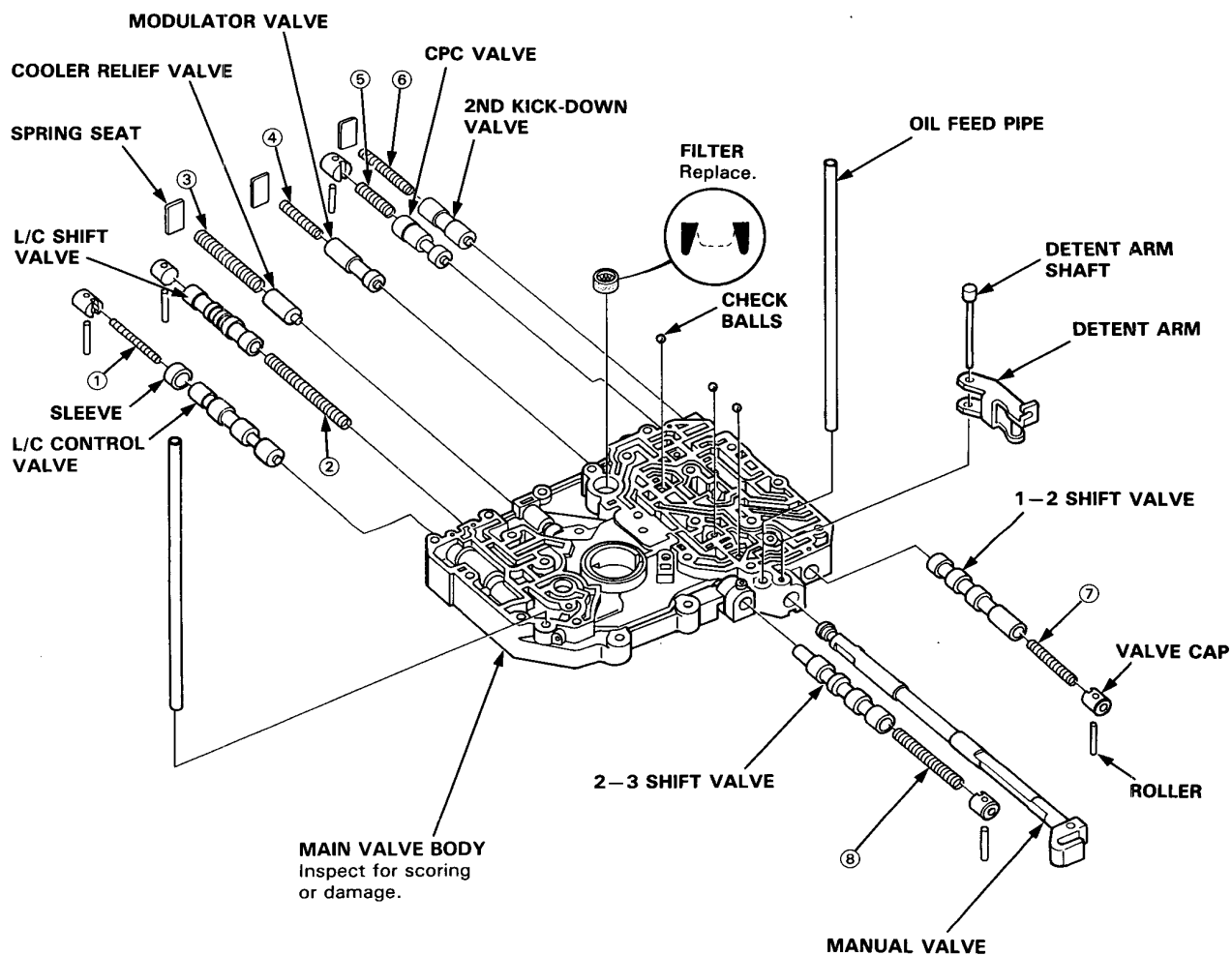

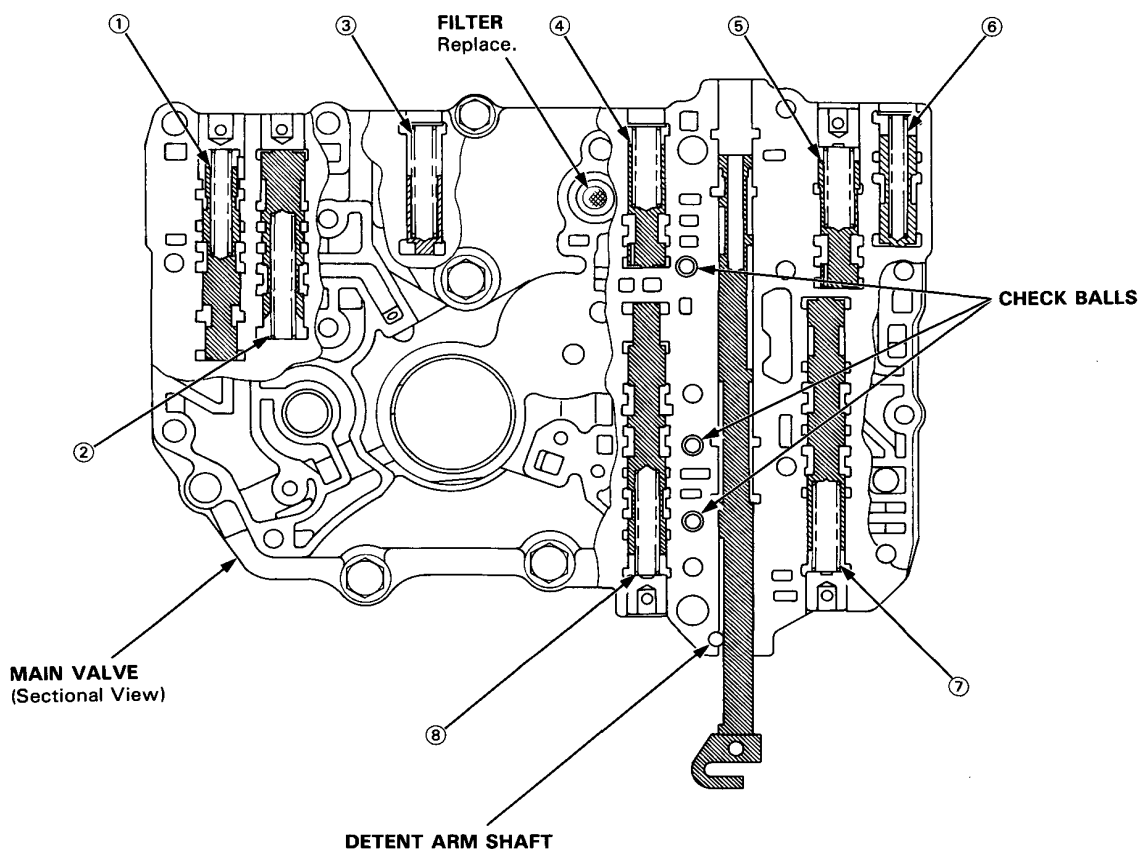

# **SPRING SPECIFICATIONS**

Unit of length: mm (in)

No.	SPRINGS	STANDARD (NEW)			
		WIRE DIA.	O.D.	FREE LENGTH	No. of COILS
①	Lock-up control valve spring	0.7 (0.028)	6.6 (0.260)	38.0 (1.496)	14.1
②	Lock-up shift valve spring	0.9 (0.035)	7.6 (0.299)	73.7 (2.902)	32.0
③	Cooler relief valve spring	1.1 (0.043)	8.4 (0.331)	46.8 (1.843)	17.0
④	Modulator valve spring	1.4 (0.055)	9.4 (0.370)	33.0 (1.299)	10.5
⑤	CPC valve spring	1.4 (0.055)	9.4 (0.370)	33.0 (1.299)	10.5
⑥	2nd kick-down valve spring	1.2 (0.047)	7.1 (0.280)	46.9 (1.846)	20.6
⑦	1-2 shift valve spring	1.0 (0.039)	8.6 (0.339)	41.3 (1.626)	16.9
⑧	2-3 shift valve spring	0.9 (0.035)	7.6 (0.299)	57.0 (2.244)	26.8